

# Nut MR3, series CM1

- for cylinder mounting
- Suitable piston Ø 8, 10 16 20, 25 32 mm
- for series ICM



Weight

See table below

## Technical data

Part No.	Piston Ø	Thread size	Weight
0413215803	8, 10 mm	M12x1,25	0,05 kg
0413214505	16 mm	M16x1,5	0,004 kg
0413214602	20, 25 mm	M22x1,5	0,004 kg
0413214718	32 mm	M30x1,5	0,01 kg

## Technical information

Material	
Material	Polyamide fiber-glass reinforced

## Dimensions

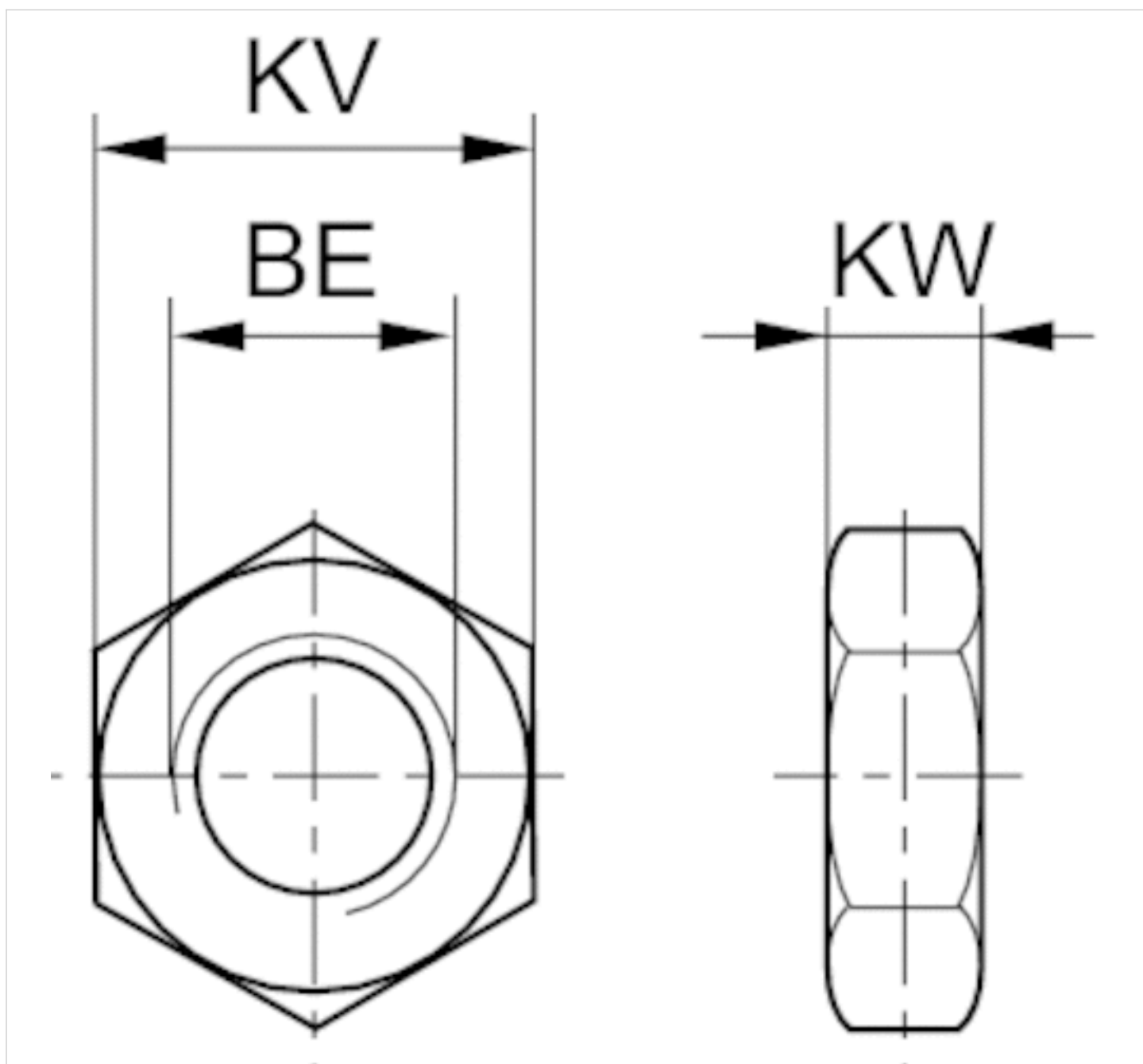

## Dimensions

Part No.	Piston Ø	For series	BE	KV	KW
0413215803	8, 10 mm	ICM	M12x1,25	17	6.75
0413214505	16 mm	ICM	M16x1,5	24	7
0413214602	20, 25 mm	ICM	M22 x1,5	30	8
0413214718	32 mm	ICM	M30x1,5	41	11

# Efficient pneumatic solutions, our program: cylinders and drives, valves and valve systems, air supply management



Visit us: [Emerson.com/Aventics](https://www.emerson.com/Aventics)

Your local contact: [Emerson.com/contactus](https://www.emerson.com/contactus)



[Emerson.com](https://www.emerson.com)



[Facebook.com/EmersonAutomationSolutions](https://www.facebook.com/EmersonAutomationSolutions)



[LinkedIn.com/company/Emerson-Automation-Solutions](https://www.linkedin.com/company/Emerson-Automation-Solutions)



[Twitter.com/EMR\\_Automation](https://twitter.com/EMR_Automation)

An example configuration is depicted on the title page. The delivered product may thus vary from that in the illustration. Subject to change. This Document, as well as the data, specifications and other information set forth in it, are the exclusive property of AVENTICS GmbH. It may not be reproduced or given to third parties without its consent. Only use the AVENTICS products shown in industrial applications. Read the product documentation completely and carefully before using the product. Observe the applicable regulations and laws of the respective country. When integrating the product into applications, note the system manufacturer's specifications for safe use of the product. The data specified only serve to describe the product. No statements concerning a certain condition or suitability for a certain application can be derived from our information. The information given does not release the user from the obligation of own judgement and verification. It must be remembered that the products are subject to a natural process of wear and aging.

The Emerson logo is a trademark and service mark of Emerson Electric Co. Brand logotype are registered trademarks of one of the Emerson family of companies. All other marks are the property of their respective owners. © 2020 Emerson Electric Co. All rights reserved.  
2020-12



**CONSIDER IT SOLVED™**